

Mx ALC INSTALLATION INSTRUCTIONS

We at Mx ALC appreciate your purchase of the Mx ALC for your motorcycle.

If you have any problems or questions, please contact us at info@mxalc.com

Whenever you see symbols, heed their instructions! Always follow safe operating and maintenance practices

WARNING

WARNING

indicates a hazardous situation which, if not avoided, could result in death or serious injury.

CAUTION

CAUTION

indicates a hazardous situation which, if not avoided, could result in minor or moderate injury.

WARNING

Installing these parts can cause a crash, serious injury or death.
Installing these parts can cause damage on your bike and equipment.

Before you start:

Read these instructions and those in the OEM Service Manual for removing and installing fork tubes, as applicable. If you are not sure that you can follow the instructions, have these installed by a professional mechanic. Refer to the OEM Service Manual for proper torque values. Keep all of your OEM parts, as some parts they will be utilized in conjunction with the installation of your Mx ALC.

CAUTION

The Mx ALC kit is designed for use with your OEM plastic fork guards.

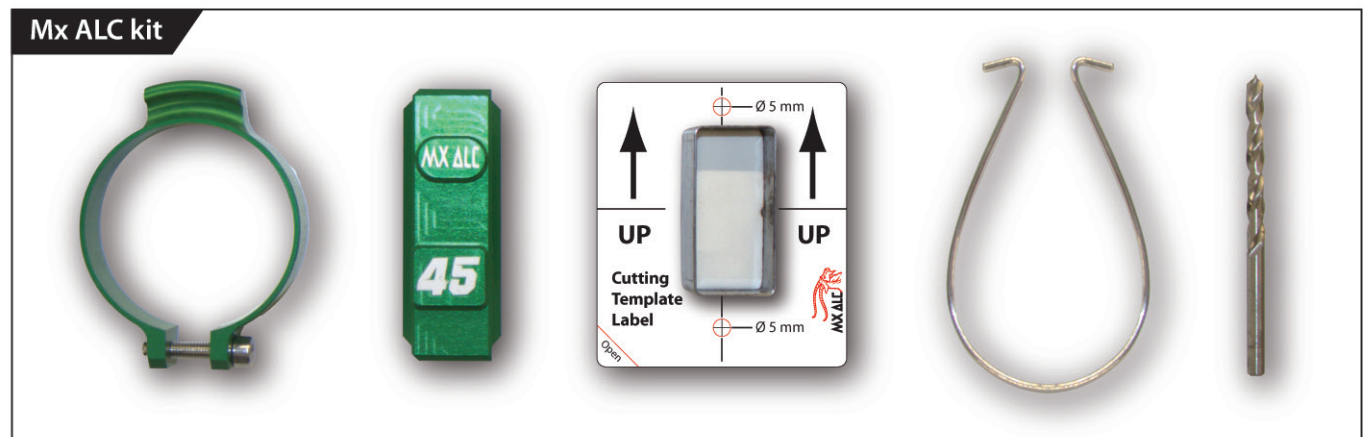

TOOLS & SUPPLIES REQUIRED: (not supplied)

- Torque wrench
- Common Hand Tools (4mm Allen wrench)
- Hand Drill
- Loctite#242 (Blue)

CAUTION

Before you begin working, be sure you are wearing eye protection and gloves.

INSTALLATION AND ASSEMBLY OF Mx ALC

1. Clean the bike before installation with special care for the fork tubes and fork guards.
2. Take cutting template and peel of back side to position it on highest point of the fork guard. Attach to fork guard. See figure 1.
3. Remove the front wheel and fork guard with the cutting template. See figure 2.
4. Using 5mm drill bit mark holes. See figure 3.



CAUTION If miss drill fork guard plastic should not be used to continue assembly. if not used properly drill bit could result in injury!

5. Take the fork guard with the cutting template and place it in the vice so that jaws of vice are fully allied with cutting device. Tighten up vice to cut through plastic. See figure 4.



CAUTION Cutting edge of tool is very sharp and can Cause injury if not used whit caution!

6. Remove fork guard from vice and then carefully remove cutting tool from plastic. If needed trim plastic edges. See figure 5.
7. Place Mx ALC housing on fork guard, flip it and screw tight with supplied bolts. Remember to apply thread Loctite and torque screws to 8Nm. See figure 6.
8. Re-install your fork guard and front wheel according to the service manual. Ensure all fasteners are properly torqued. See figure 7.
9. Take Mx ALC ring and omega shaped tool, place tool around fork and attach it to the ring bolt holes. Pull fast and hard so the ring passes on the fork.
10. Determine your correct preload position by moving the fork ring up and down the fork depending on your skill level and track condition. The final step is to align fork ring and trigger mechanism and screw the ring tight using Loctite. See figure 9.
11. Test device by opening the gate and push in trigger mechanism inward until you hear a click. While holding your front brake push down front end of the bike. After you lock down push one more time to deactivate. See figure 10.



CAUTION

After your first ride:

Inspect your Mx ALC, front fork and fork guard. Check the torque on all the fasteners of your steering system. Regular checks and maintenance: Periodically check all the nuts and bolts to ensure that they are properly fastened and torqued, especially after adjustments. General Maintenance intervals are specified in your OEM Service Manual. If adjustment is needed, follow the guidelines in your OEM Service Manual.

In the event of a crash:

1. Remove and inspect the Mx ALC. Look for damage, deformation or looseness.
2. Inspect your forks for any sign of damage or damaged parts.



WARNING

Operating the motorcycle with damaged parts can cause a crash, serious injury or death. If you aren't sure whether your Mx ALC is damaged, return it to Mx ALC for inspection and evaluation.



CAUTION

AFTER EVERY RIDE-Flush the inside of the fork guard/trigger mechanism to clear any debris with WD40.

Congratulations. You have now completed the installation of your Mx ALC for your motorcycle.

Figure 1.



Figure 2.



Figure 3.

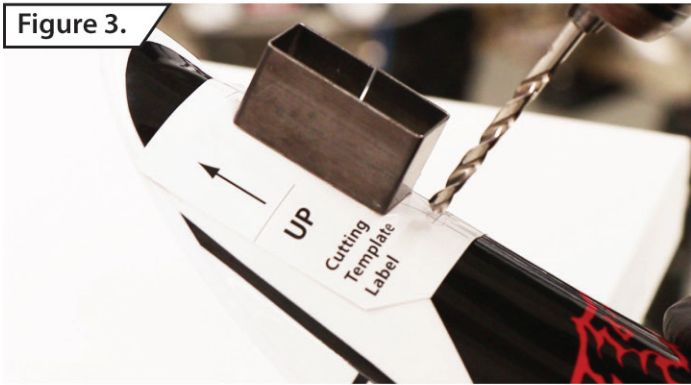

Figure 4.

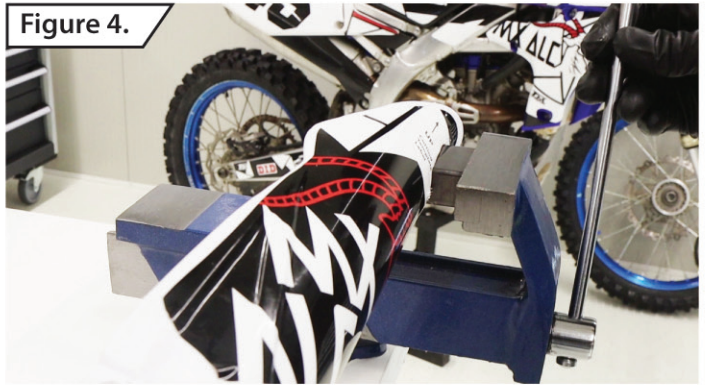

Figure 5.



Figure 6.



Figure 7.



Figure 8.



Figure 9.



Figure 10.

